

SPA OPERATION AND MAINTENANCE

Assuring that your spa will perform and look like it did when you bought it requires a little upkeep. Below are some tips for properly maintaining your spa.

Cleaning the Shell

- Use a nonabrasive household cleaner to clean all spa shell surfaces and fixtures.
- Do not use cleaning agents containing strong abrasives such as scouring powders, or strong solvents such as gasoline, acetone, or denatured alcohol; damage to the acrylic finish will result.
- Be sure to use a soft absorbent cloth with any of the commercially available nonabrasive foam or liquid agents in general cleaning concentrations.
- Always rinse thoroughly with clean water and a soft chamois or moist cellulose sponge.
- Fine scratches may be minimized by the use of a mild automobile cleaner-polish. The cleaner-polish has a fine abrasive action, and its wax content tends to fill small scratches to make them less visible.

Cover Maintenance

Your spa cover is normally exposed to very harsh sunlight. It is important that when your cover becomes soiled to try to remove the potential stain as soon as possible. To remove stains use mild soap and a cloth. And to continue to maintain the beauty of your cover you can also use a vinyl restoring cleaner.

Cabinet Maintenance

Your Durabilt™ Synthetic Cabinet is made completely of a synthetic material. To clean, take a dampened rag with mild dish soap and wash the outside panels.

Winterizing Your Spa

Please see your local dealer for assistance on winterization.

NOTE: Damage caused by improper winterization will NOT be covered under warranty.

Cleaning the Filter

Your spa is equipped with what we believe is the finest filtering device available. We call it the Skim/Filter system, and it is one of the few skimmers available which actually skims the water surface. You'll notice a distinct whirlpool being drawn into the system, and floating debris of all sizes will literally "fall" into the unit and be trapped by the filter. It is important that you keep your filter clean, and it is suggested that you check the filter at least once per month and replace it when it becomes loaded with dirt or debris.

Filter Basket and Cartridge Removal and Replacement Procedure

1. Turn off electrical power to the spa.
2. Remove the floating weir and attached basket by rotating it counterclockwise to align the flat tabs on the filter housing flange with the flat areas on the floating weir and basket assembly, then lift out the assembly.
3. Lift the filter cartridge straight up and out of the filter housing, quickly moving it away from the tub to prevent collected debris from falling back into the water.
4. Separate the floating weir from the basket by rotating it counterclockwise to align the notches on the floating weir flange with the tabs on the top of the basket, then simply pull them apart.
5. Clean any accumulated debris from the basket. Avoid hitting the basket against objects to knock debris loose, as this will break the basket.
6. Re-attach the basket to the floating weir.
7. Install a new filter cartridge in the filter housing.
8. Reinstall the floating weir and attached basket assembly.
9. Turn electrical power to your spa back on.



SPA OPERATION AND MAINTENANCE

continued

Chemical Safety Tips

- Never mix different types of chemicals or contaminate them in any way.
- Do not exceed recommended dosages.
- After superchlorinating/brominating, wait until the disinfectant level is down 3–5 parts per million (ppm) before using the spa.
- Keep chemicals out of reach of children and pets.
- Keep containers closed when not in use.
- Do not use contents of unlabeled containers.
- Never add water to chemicals. If called for by the instructions, add chemicals to water.
- Dispose of empty containers as instructed on the label.
- Never handle chemicals with your bare hands.
- Store chemicals in a cool, dry, clean place (not under spa).
- Remove cover when superchlorinating/brominating. Wait at least one hour (with circulating system or low-spa speed pump on) before replacing the cover. Doing so will prolong life of cover.

NOTE: Check and maintain your water chemistry at least twice a week for proper levels.

SPA FROG® In-Line System

Your spa came with the most advanced, revolutionary sanitation system available today. When using the unique SPA FROG Mineral Cartridge with the exclusive SPA FROG Bromine Cartridge, you'll enjoy your spa more with less work and less bromine.

NOTE: If you purchased a 200-series spa, your spa came equipped with a floating system rather than the in-line version. For the floating system instructions, please see the instruction card included in your information packet.

Less Work Because:

- Minerals continuously work to control bacteria for up to four full months.
- Cartridges last longer to eliminate daily maintenance.
- Cartridges are pre-filled for no measuring or mess.
- Simply adjust to your setting and relax for weeks.

Less Bromine Because:

- With minerals in the water, bromine use is cut by up to 50%.*
- Bromine lasts longer: 2–4 weeks on a 350 gallon spa with average use.
- With minerals and low levels of bromine, the water feels softer.
- The system reduces odors and leaves the water crystal clear.
- SPA FROG has the only minerals that work with bromine.

*Compared to the ANSI/NSPI recommended minimums for bromine in a spa.

The SPA FROG In-Line System is Made Up of:

- A Frog cap that is easily distinguishable among the fittings on the top of the spa.
- A Cartridge holder that pulls out the system.
- A Mineral Cartridge that controls bacteria in the water.
- A Bromine Cartridge that helps support the minerals while oxidizing contaminants like body oils. The cartridges are adjustable to meet your specific spa water care needs.

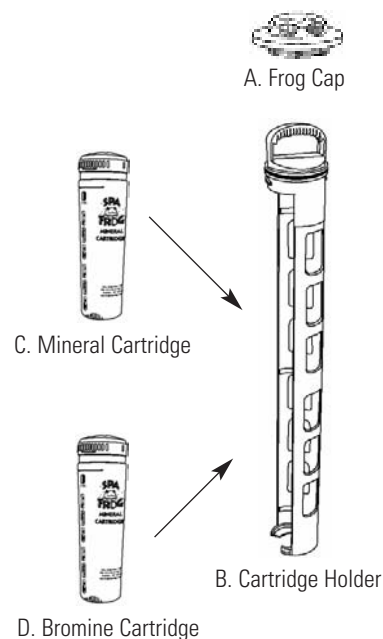

SPA OPERATION AND MAINTENANCE

continued

SPA FROG In-Line System

Start Up

- A. Open cap of SPA FROG In-Line System and set aside.
DO NOT OPEN CAP WHILE JETS ARE ON.
- B. Remove holder by pushing down and turning counterclockwise before pulling out.
- C. Snap the Mineral Cartridge into the area marked "Minerals" (top portion) and the Bromine Cartridge into the area marked "Bromine" (bottom portion) making sure to line up the indentation at the top of the cartridges with the raised area on the holder.
- D. Slowly insert holder into system. Line up holder arrow (1) with system arrow (2) push down until holder tabs (3) go past system tabs (4) and turn holder to the right (clockwise) until it stops. To ensure a locked position, attempt to pull holder up. If it stays in place, the lock is secure.
- E. Begin regular spa care procedures as soon as start-up is complete.

NOTE: Using Bromine Cartridge in the area marked "Minerals" can cause over bromination which shortens cartridge life.

Adjusting and Replacing Mineral Cartridge

- F. Open Mineral Cartridge wide open to setting #6 by holding the top of the unit and turning the bottom counterclockwise until #6 appears in the setting window. The Mineral Cartridge must be placed every 4 months. For ease in remembering, mark you calendar with the Reminder Stickers included in the package with chemical cartridges or replace the SPA FROG Mineral Cartridges every time you drain and fill you spa (every 90 to 120 days).

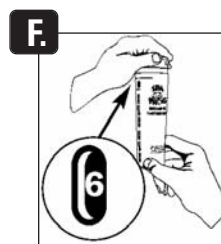
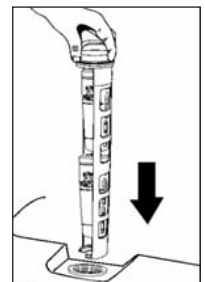
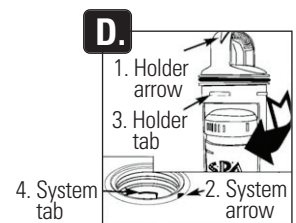
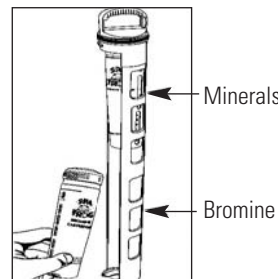
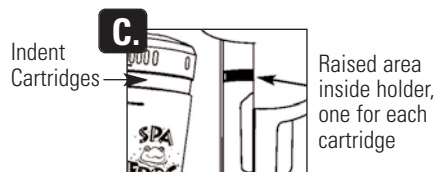
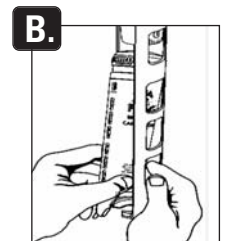
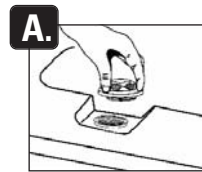

Adjusting and replacing mineral cartridge

